

| DATE | REVISIONS | REV |
|---------|--|-----|
| 9-16-92 | REDRAWN, CHG'D DIA. FROM 4.8 TO 4.85 MAX./ | A |
| 9-12-95 | REDRAWN, UPDATED SAFE OPER. SPECS./ | B |

| | |
|---------------------------------|----------|
| DRAWING NUMBER SSL-LX509F3YD | REV B |
|---------------------------------|----------|

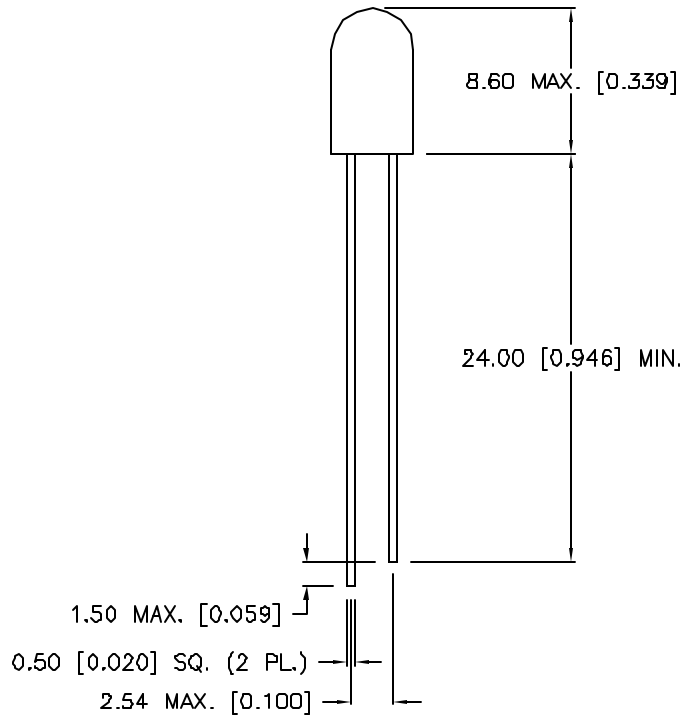
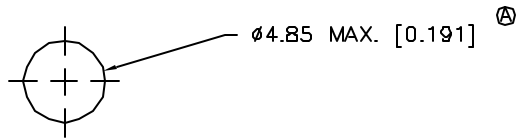

ELECTRO-OPTICAL CHARACTERISTICS $T_A = 25^\circ\text{C}$ $I_f = 20\text{mA}$

| PARAMETER | MIN | TYP | MAX | UNITS | TEST COND |
|-------------------|-----------------|--------------|-----|----------|------------------------|
| PEAK WAVELENGTH | | 585 (YELLOW) | | nm | |
| FORWARD VOLTAGE | | 2.1 | 2.8 | V_f | |
| REVERSE VOLTAGE | 5.0 | | | V_r | $I_f = 100\mu\text{A}$ |
| AXIAL INTENSITY | | 20 | | mcd | $I_f = 20\text{mA}$ |
| VIEWING ANGLE | | 80 | | 2x theta | |
| EMITTED COLOR | YELLOW | | | | |
| EPOXY LENS FINISH | YELLOW DIFFUSED | | | | |

[Ⓑ] LIMITS OF SAFE OPERATION AT 25°C

| PARAMETER | MAX | UNITS |
|-------------------------|------------|------------|
| PEAK FORWARD CURRENT* | 150 | mA |
| STEADY CURRENT | 30 | mA |
| POWER DISSIPATION | 105 | mW |
| DERATE FROM 25°C | -1.2 | mW/°C |
| OPERATING, STORAGE TEMP | -40 TO +85 | °C |
| LEAD SOLDERING TEMP | +260 | °C |
| 2.0mm FROM BODY | | 3 SEC. MAX |

* $t < 10\mu\text{s}$

RELIABILITY NOTE
OUR MANY YEARS OF EXPERIENCE DATA ACCUMULATION INDICATE THAT SOLDER HEAT IS A MAJOR CAUSE OF EARLY AND FUTURE FAILURE. PLEASE PAY ATTENTION TO YOUR SOLDERING PROCESS.



292 E. HELLEN ROAD
PALATINE, ILLINOIS 60067
(708) 359-2790

CONFIDENTIAL INFORMATION
THE INFORMATION CONTAINED IN THIS DOCUMENT IS THE PROPERTY OF LUMEX OPTO/COMPONENTS, INC. EXCEPT AS SPECIFICALLY AUTHORIZED IN WRITING BY LUMEX OPTO/COMPONENTS, INC., THE HOLDER OF THIS DOCUMENT SHALL KEEP ALL INFORMATION CONTAINED HEREIN CONFIDENTIAL AND SHALL PROTECT SAME IN WHOLE OR IN PART FROM DISCLOSURE AND DISSEMINATION TO ALL THIRD PARTIES.

| | | | |
|---------------|------|--------|-------|
| DATE: 4-10-92 | DWN: | CHK'D: | APPD: |
| SCALE: N/A | | | |

T-5 (T-1 3/4) FLANGELESS LED,
YELLOW DIFFUSED

| | | |
|-------------|---------------------------------|----------|
| PAGE 1 OF 1 | DRAWING NUMBER SSL-LX509F3YD | REV B |
|-------------|---------------------------------|----------|