

J Type

Conventional Part No. Global Part No. Lighting Color
 LN1251C-(TR).....LNJ251C4RRA.....Red
 LN1351C-(TR).....LNJ351C4GRA.....Green
 LN1451C-(TR).....LNJ451C4XRA.....Amber
 LN1851C-(TR).....LNJ851C4DRA.....Orange

■絶対最大定格 Absolute Maximum Ratings (T_a = 25°C)

Lighting Color	P _D (mW)	I _F (mA)	I _{FP} (mA)*	V _R (V)	T _{opr} (°C)	T _{stg} (°C)
Red	45	15	60	4	-25 ~ +80	-30 ~ +85
Green	45	15	60	4	-25 ~ +80	-30 ~ +85
Amber	45	15	60	4	-25 ~ +80	-30 ~ +85
Orange	45	15	60	3	-25 ~ +80	-30 ~ +85

I_{FP}の条件は、duty 10% Pulse width 1 msec. The condition of I_{FP} is duty 10%, Pulse width 1 msec

■電気的光学的特性 Electro-Optical Characteristics (T_a = 25°C)

Conventional Part No.	Lighting Color	Lens Color	I _O		I _F	V _F		λ _p	Δλ	I _F	I _R	
			Typ	Min		Typ	Max				Max	V _R
LN1251C-(TR)	Red	Clear	1.2	0.45	10	2.1	2.8	700	100	15	5	4
LN1351C-(TR)	Green	Clear	5.0	1.9	10	2.1	2.8	565	30	15	10	4
LN1451C-(TR)	Amber	Clear	2.2	0.8	10	2.1	2.8	590	30	15	10	4
LN1851C-(TR)	Orange	Clear	3.5	1.3	10	2.05	2.8	630	40	15	10	3
Unit	—	—	mcd	mcd	mA	V	V	nm	nm	mA	μA	V

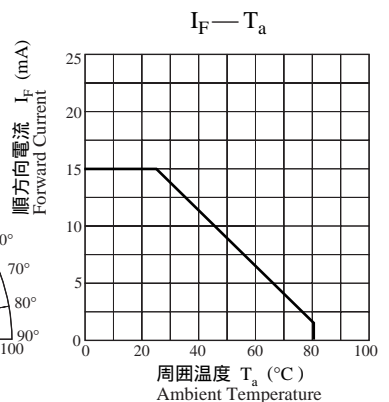
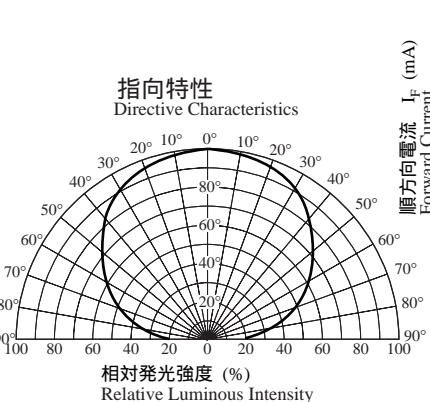
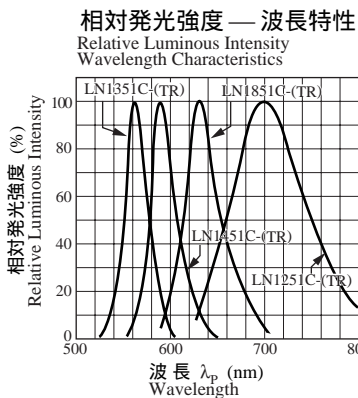
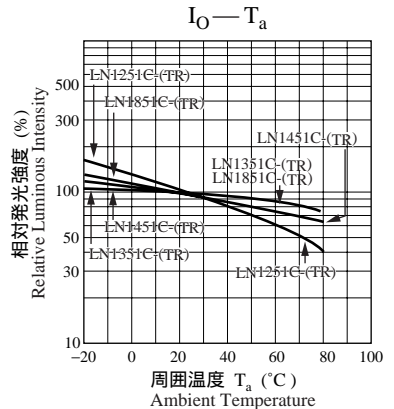
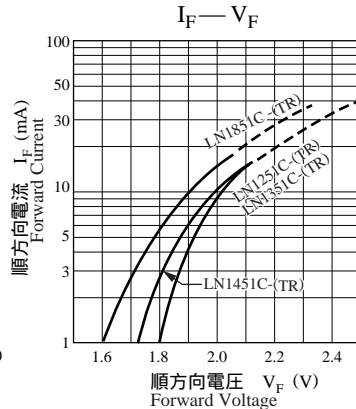
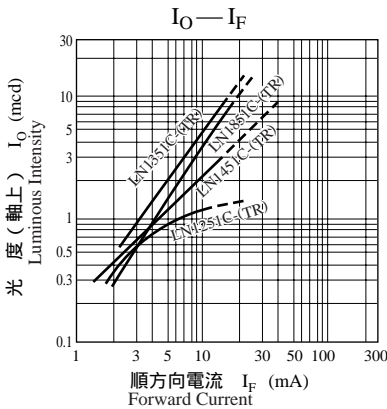
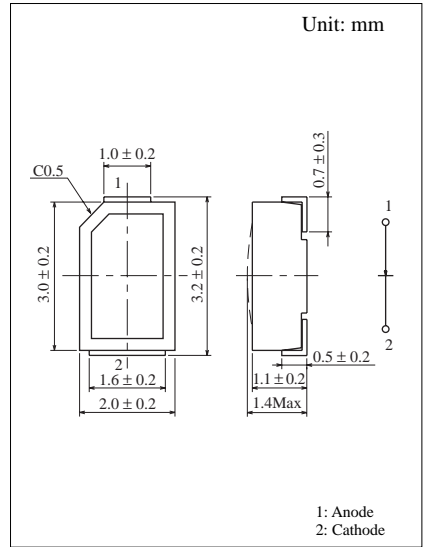

This datasheet has been download from:

www.datasheetcatalog.com

Datasheets for electronics components.